

Back Plate Frame Left Close out

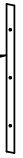

Back Plate Frame Rear Close out

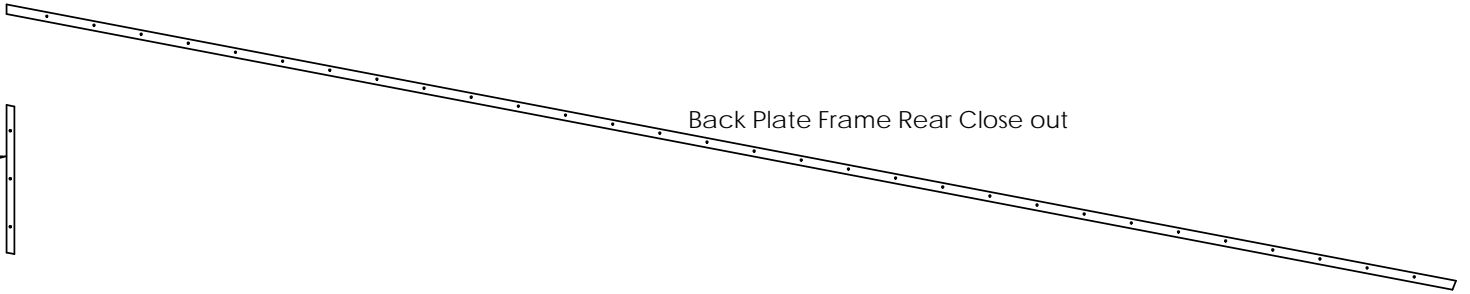

Back Plate Frame Right Close out



Back Plate Frame front Close out

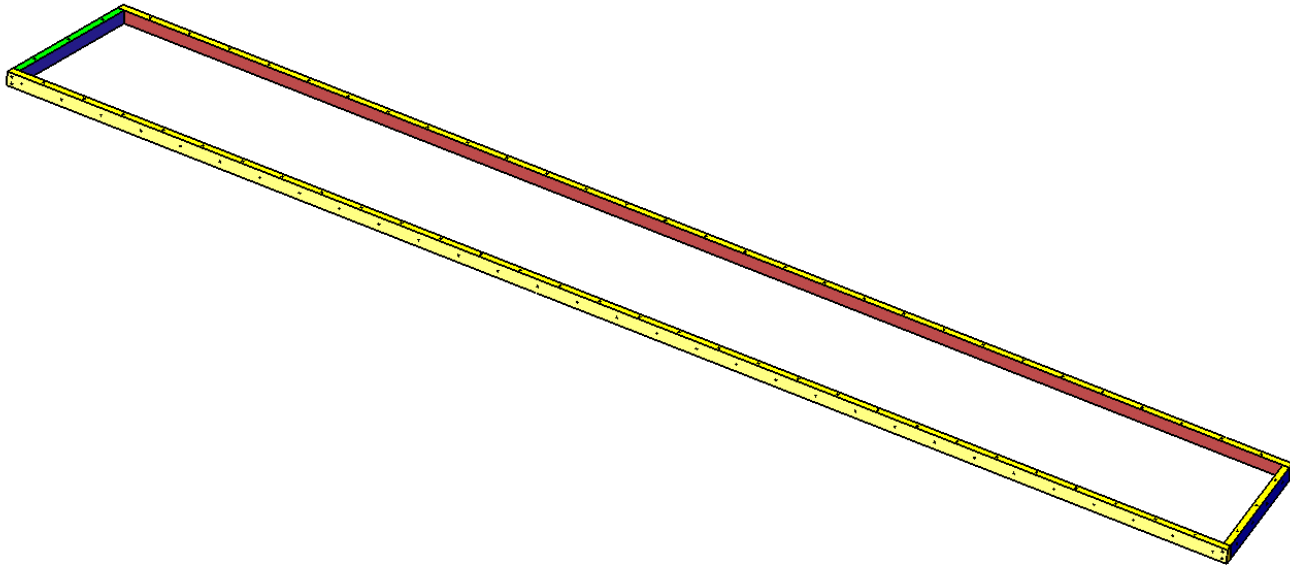
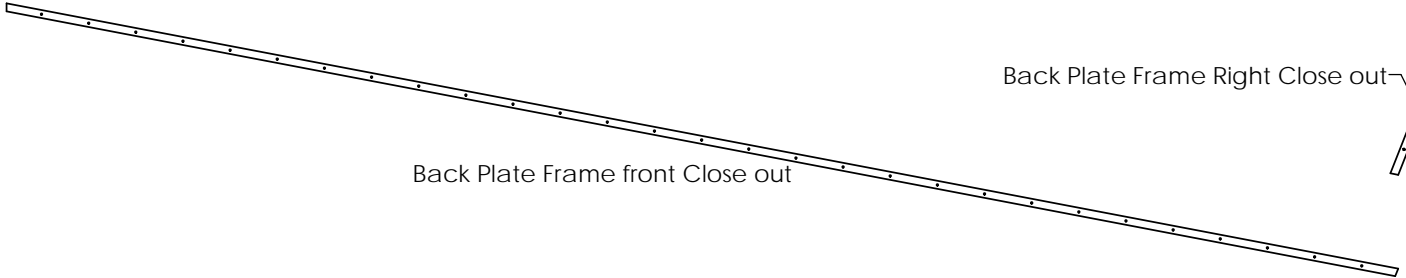

S. No	Description	Material	Quantity
1	Back Plate frame front Close Out	Aluminum Alloy 6061-T651	1
2	Back Plate Frame Rear Close Out	Aluminum Alloy 6061-T651	1
3	Back Plate Frame Right Close Out	Aluminum Alloy 6061-T651	1
4	Back Plate frame left Close Out	Aluminum Alloy 6061-T651	1

EACH SHEET OF A MULTI-SHEET DRAWING SHALL ALWAYS CARRY THE SAME REVISION LEVEL

DOCUMENT CONTROL STAMP DATE: 25 Sep 08 DRAWN BY: Kalyan Jeyaram CHECKED BY: [Signature] APPROVED BY: [Signature]	DIM & TOL PER ASME Y14.5 UNLESS OTHERWISE SPECIFIED DIMENSIONS ARE IN INCHES TOLERANCES ARE IN INCHES FINISHES: SURF. ANGLES:	TRACKING NO. APPROVED BY: [Signature] DATE: 25 Sep 08 DRAWN BY: Kalyan Jeyaram CHECKED BY: [Signature] APPROVED BY: [Signature]	U.S. Department of Energy Office of Science Jefferson Lab Jefferson Science Applications, LLC Operated by Hall B - 12 GEV Drift Chamber Sys Mech Structure Region 3 Back Plate Frame Assembly Dwg. No. B00000-01-10-0014 1:6 (SEE 3D MODEL) SHEET 1 OF 5
--	---	--	---

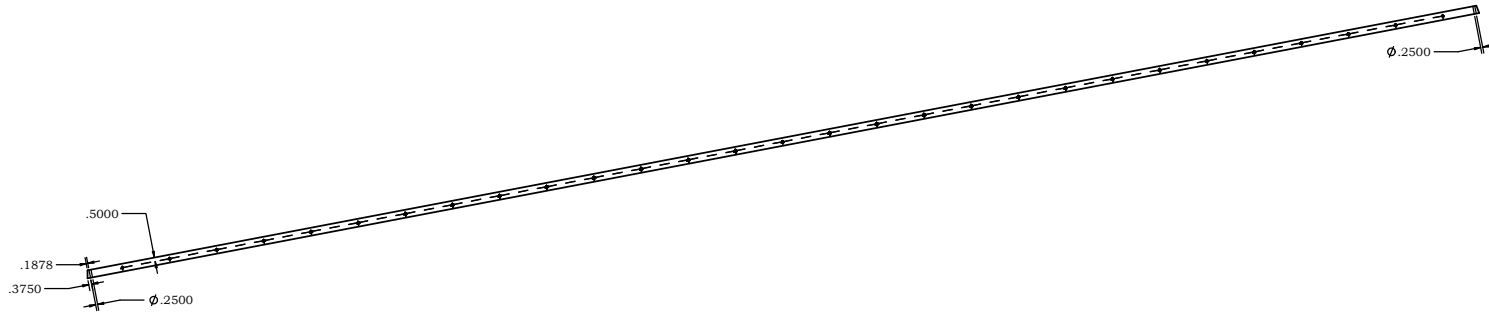
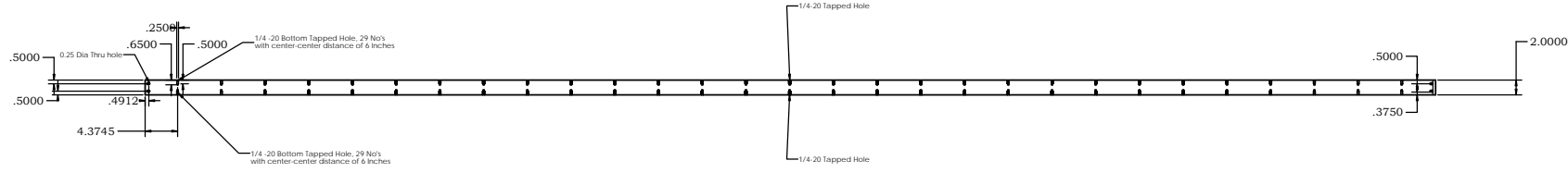
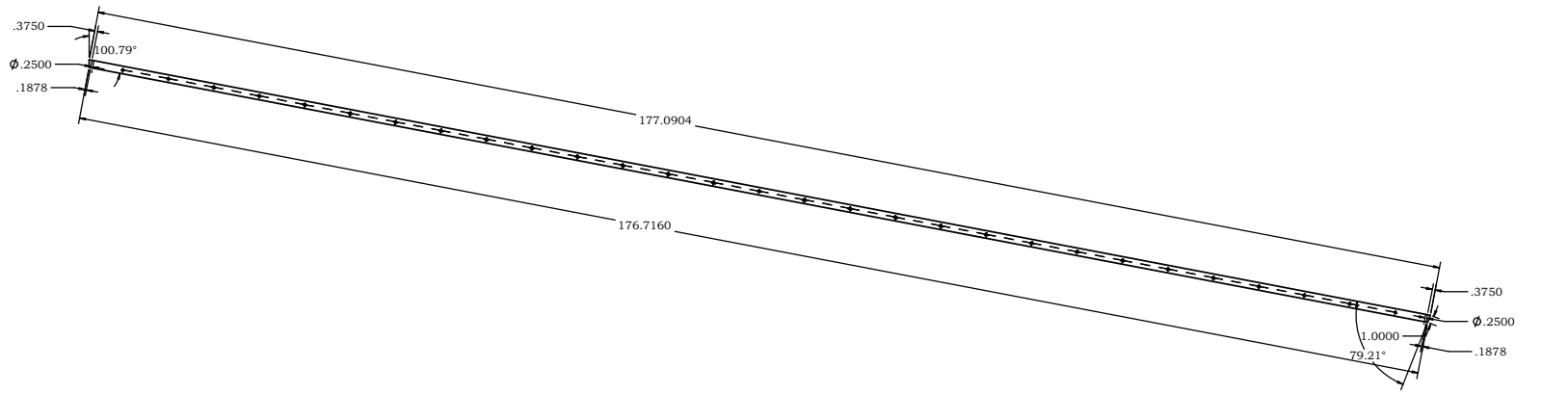

Notes

All Dimensions are in Inches
 Unless otherwise stated diametric tolerance for holes is +/- 0.003 inches
 Positional tolerance for holes is 0.006 Inches
 All holes to be burr free, however, sharp edges are permitted
 All dimensions are at 68 Deg F

DOCUMENT CONTROL STAMP		EACH SHEET OF A MULTI-SHEET DRAWING SHALL ALWAYS CARRY THE SAME REVISION LEVEL	
DRAWN BY: Aluminum Alloy 6061 T651 CHECKED: <input checked="" type="checkbox"/> OUTSIDE REVIEW APPROVED: <input type="checkbox"/>		TRACKING NO. _____ U.S. Department of Energy Jefferson Lab Operated by Jefferson Science Applications, LLC	
DATE: 25 Sep 08 DRAWN BY: Kalyan Jeyaram		HALL B - 12 GEV Drift Chamber Sys Mech Structure Region 3 Back Plate Frame Front Lipsream Close out	
DWG. NO. B00000-01-10-0014		SHEET 2 OF 5	

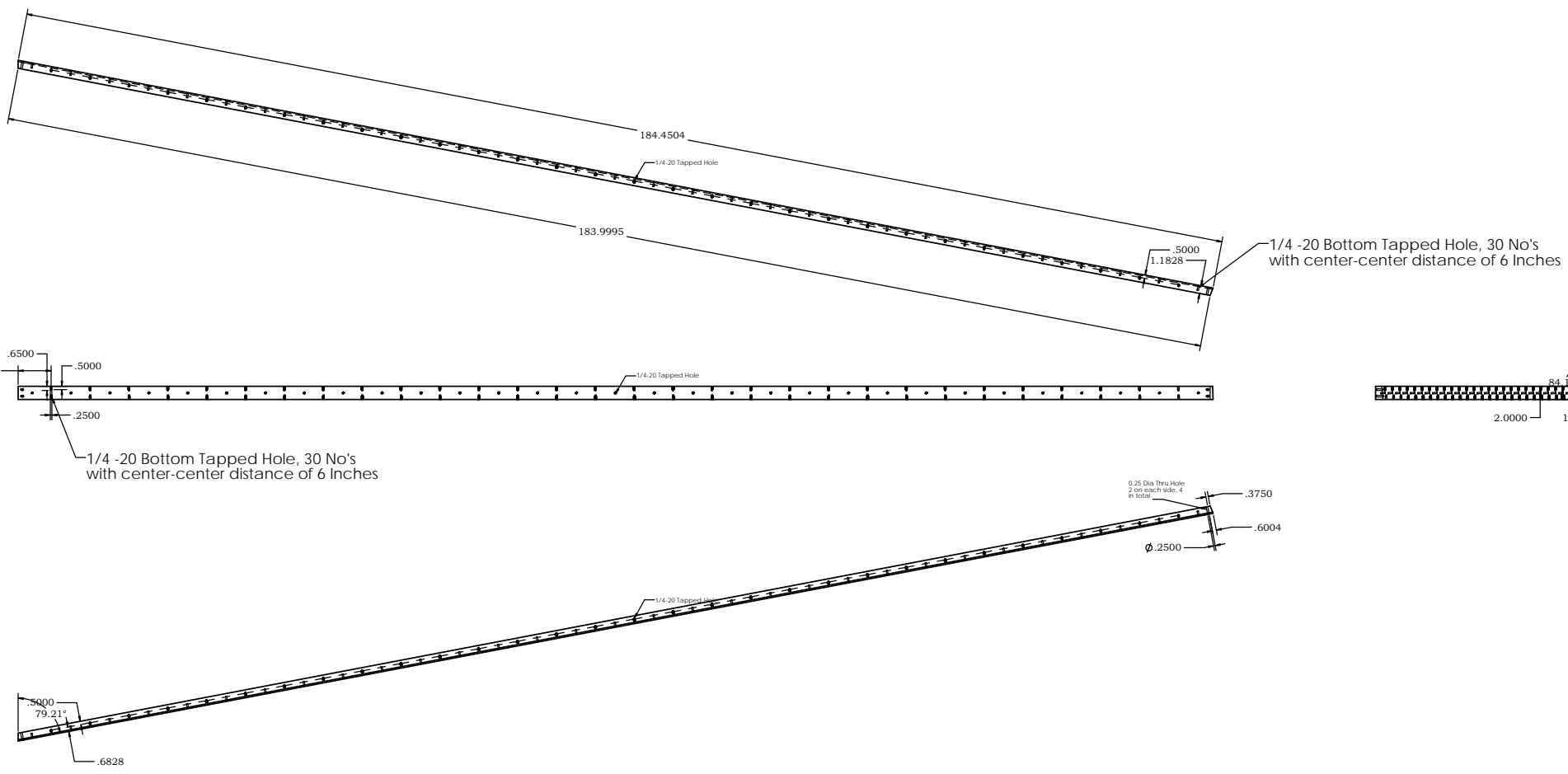

Notes

All Dimensions are in Inches
 Unless otherwise stated diametric tolerance for holes is +/- 0.003 inches
 Positional tolerance for holes is 0.006 Inches
 All holes to be burr free, however, sharp edges are permitted
 All dimensions are at 68 Deg F

DOCUMENT CONTROL STAMP		EACH SHEET OF A MULTI-SHEET DRAWING SHALL ALWAYS CARRY THE SAME REVISION LEVEL	
MATERIAL: Aluminum Alloy 6061 T651	DATE: 25 Sep 08	DRAWN: Kalyan Jeyan	DATE: 25 Sep 08
FORM MACHINED FINISHED	CHECKED ✓	APPROVED	DATE: 25 Sep 08
OTHER MATERIALS USED	OTHER DIMENSIONS NOTED	APPROVED	DATE: 25 Sep 08
DIM & TOL PER ASME Y14.5 UNLESS OTHERWISE SPECIFIED TOLERANCES ARE IN INCHES FINISHES SURF. ANGLES		TRACKING NO. APPROVED BY: [Signature] DATE:	
U.S. Department of Energy Jefferson Lab Jefferson Science Accelerator Facility Operations, LLC		Hall B - 12 GEV Drift Chamber Sys Mech Structure Region 3 Back Plate Frame - Down stream Close out	
DWG. NO.: B00000-01-10-0014		SCALE: 1:6	
SHEET 3 OF 5		1:6	

8 7 6 5 4 3 2 1

H G F E D C B A

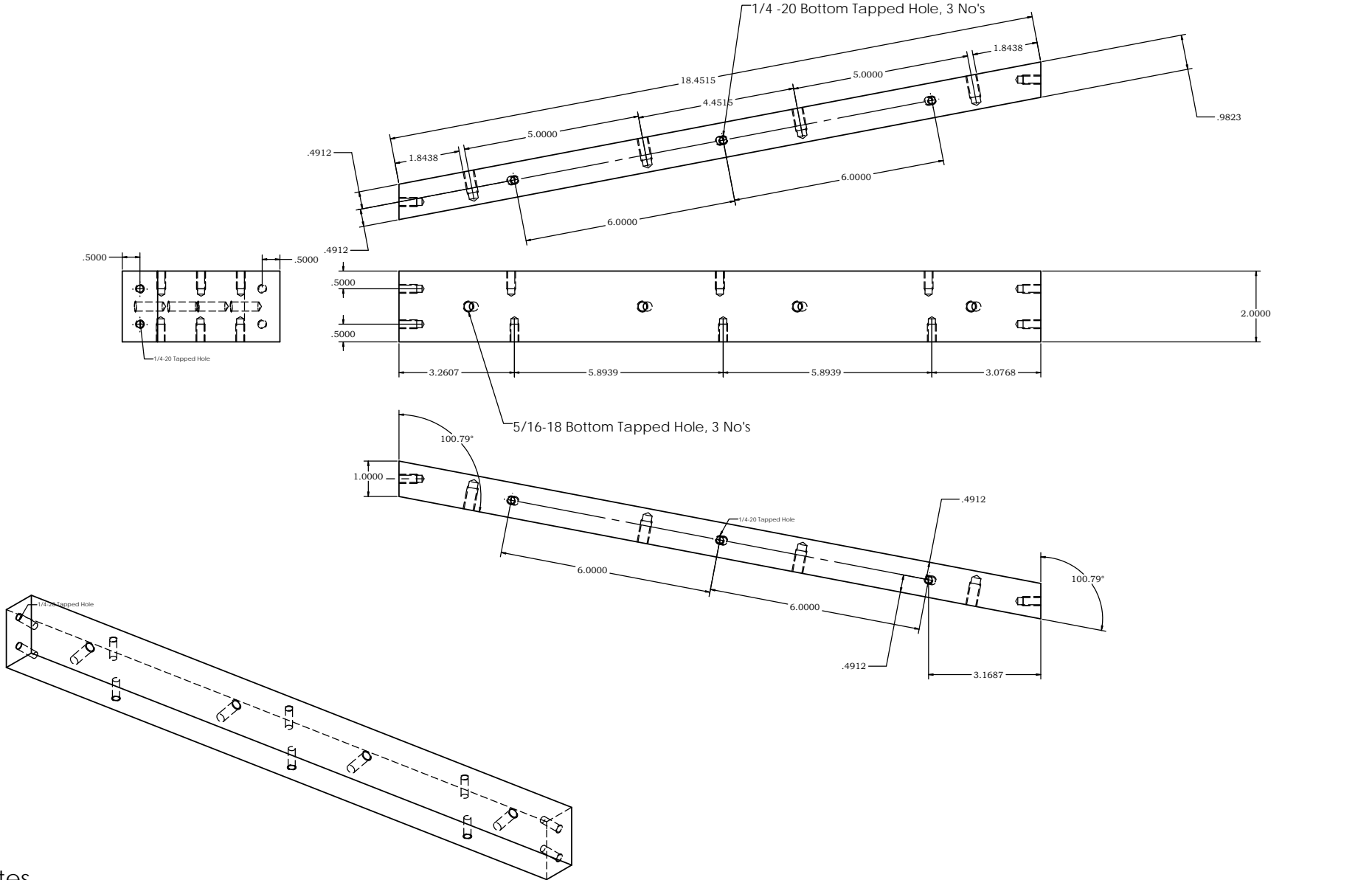

Notes

- All Dimensions are in Inches
- Unless otherwise stated diametric tolerance for holes is +/- 0.003 inches
- Positional tolerance for holes is 0.006 Inches
- All holes to be burr free, however, sharp edges are permitted
- All dimensions are at 68 Deg F

DOCUMENT CONTROL STAMP		EACH SHEET OF A MULTI-SHEET DRAWING SHALL ALWAYS CARRY THE SAME REVISION LEVEL	
DRAWN & FOR PER ASME Y14.5 DIMENSIONS UNLESS OTHERWISE SPECIFIED TOLERANCES ARE IN INCHES FINISHES SURF. ANGLES		TRACKING NO. APPROVED BY DATE DRAWN Kalyan Jeyan 25 Sep 08	
MATERIAL: Aluminum Alloy 6061 T651		U.S. Department of Energy Office of Science Jefferson Lab Operated by Jefferson Science Associates, LLC	
FROM MACHINED SURFACES UNLESS OTHERWISE NOTED DIMENSIONS ARE AT ALL SURFACES		Hall B - 12 GEV Drift Chamber Sys Mech Structure Region 3 Back Plate Frame Right Close out	
<input checked="" type="checkbox"/> CHECKED <input type="checkbox"/> APPROVED		SIZE: 1:1 DWG. NO.: B00000-01-10-0014 SHEET 4 OF 5	

8 7 6 5 4 3 2 1

H G F E D C B A

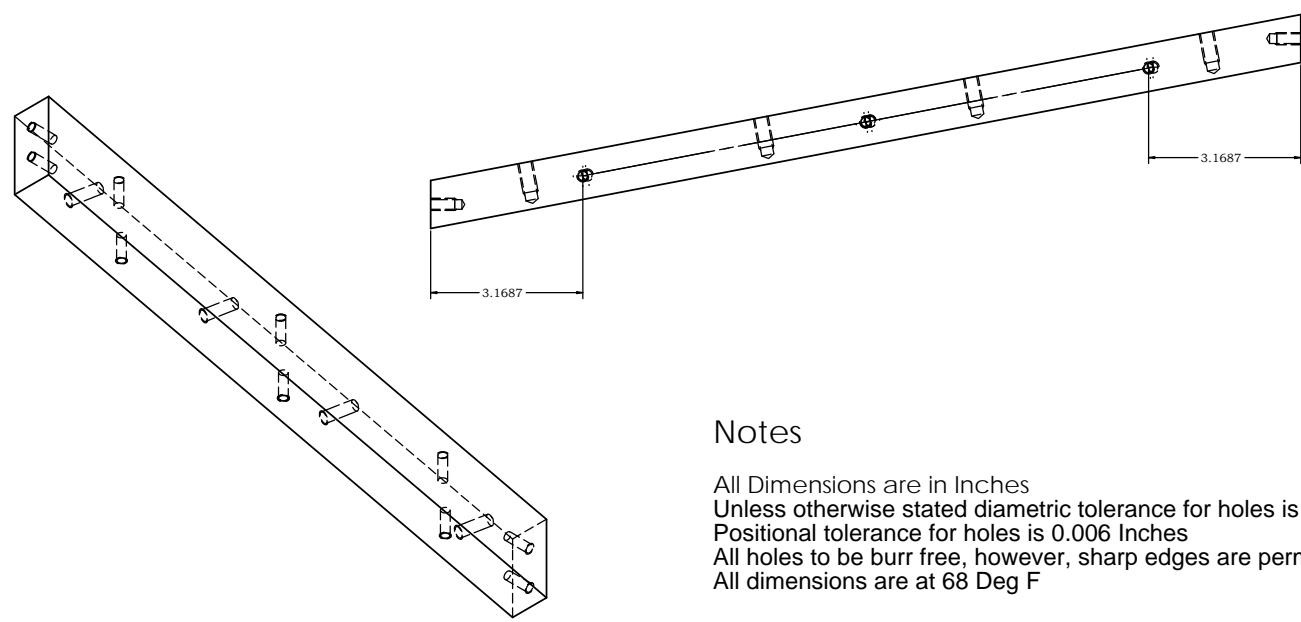
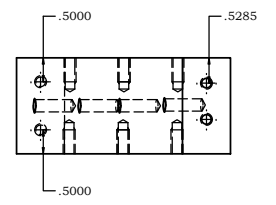
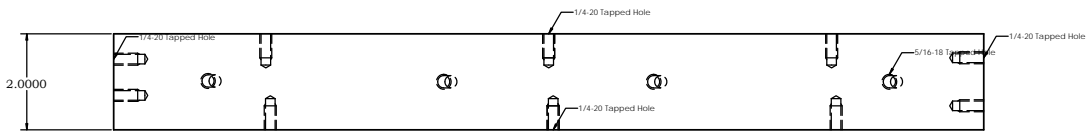
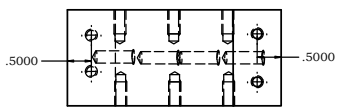
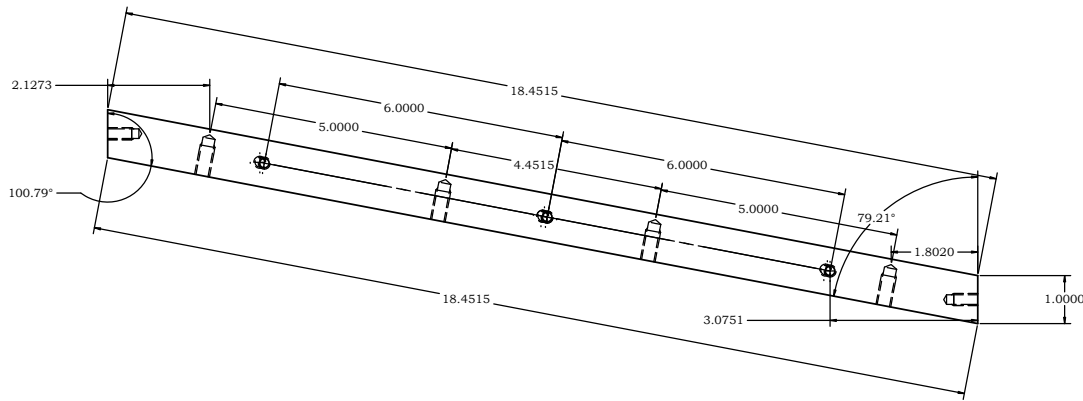

Notes

- All Dimensions are in Inches
- Unless otherwise stated diametric tolerance for holes is +/- 0.003 inches
- Positional tolerance for holes is 0.006 Inches
- All holes to be burr free, however, sharp edges are permitted
- All dimensions are at 68 Deg F

DOCUMENT CONTROL STAMP		EACH SHEET OF A MULTI-SHEET DRAWING SHALL ALWAYS CARRY THE SAME REVISION LEVEL		TRACKING NO.		U.S. Department of Energy Office of Science		 Operated by Jefferson Science Applications, LLC	
MATERIAL: Aluminum Alloy 6061 T651		FINISH: MACHINED UNPOLISHED		DRAWN: Kalyan Jeyan		DATE: 25 Sep 08		Hall B - 12 GEV Drift Chamber Sys Mech Structure Region 3 Back Plate Frame Left Close out	
DIM & TOL PER ASME Y14.5 UNLESS OTHERWISE SPECIFIED TOLERANCES ARE IN INCHES FINISHES: SURF. ANGLES		CHECKED: 		APPROVED:		SIZE: R.		DWG. NO.: B00000-01-10-0014	
APPROVED: 		APPROVED: 		APPROVED: 		APPROVED: 		1:1 SHEET 5 OF 5	